

# CIERRE 791 LATCH

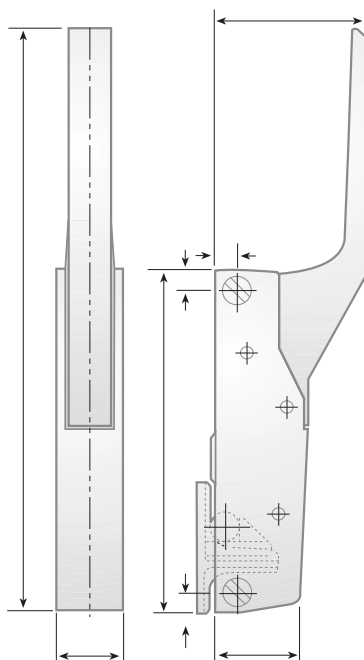

**Cierre y nariz**  
 Caja: Zamak 5 cromado brillo  
 Maneta: Zamak 5 cromado brillo  
 Rodillo latón  
 4 Tornillos de Ø 5 mm.  
 Fuerza de cierre: 15 Kgs.

**Latch and strike**  
 Housing: Zamak 5 chrome plated  
 Handle: Zamak 5 chrome plated  
 With brass roller  
 4 Screws of Ø 5 mm  
 Fastening force: 15 kgs.



| 791 Sin llave / Without key |                |                                       |                                 | CIERRE<br>LATCH | 796 Con llave / With key |                |                                       |                                 |
|-----------------------------|----------------|---------------------------------------|---------------------------------|-----------------|--------------------------|----------------|---------------------------------------|---------------------------------|
| Modelo<br>Version           | Código<br>Code | Nariz<br>Strike                       | Peso <sup>(gr.)</sup><br>Weight |                 | Modelo<br>Version        | Código<br>Code | Nariz<br>Strike                       | Peso <sup>(gr.)</sup><br>Weight |
| 791                         | FI0.0278       | Escuadra<br>Zamak 5<br>epoxi<br>negro | 610                             |                 | 796                      | FI0.0280       | Escuadra<br>Zamak 5<br>epoxi<br>negro | 620                             |